



# LB910 Compact

1. Open the upper door of machine



2. Place the capsule in the specially shaped compartment, as shown in the picture.

3. Close the upper door.

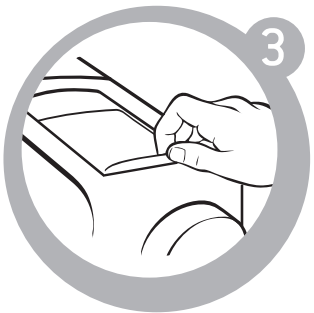

4. Place the cup on the cup-support rack and press the upper coffee button: **manual brewing**. When you have the desired coffee quantity, stop dispensing the coffee by pushing again the same button.

5. Place the cup on the cup-support rack and press the lower coffee button: **automatic brewing**. When the pre-dosed quantity of coffee is reached, the brewing will stop automatically.



- Plug the machine to a power supply of 220/240 V
- Fill with water the transparent tank placed on the machine side
- Turn on the machine by pushing the button placed on the machine side
- Wait for the machine's buttons are illuminated before making your coffee
- Do not open, perforate, empty content of capsules
- Empty content of drawers regularly